

Cascade Valley Hospital

ARLINGTON - FLOOR 1

330 S. Stillaguamish Ave., Arlington
360-435-2133 | SkagitRegionalHealth.org

5 Directions from I-5

- Exit #208 to WA-530
- Continue for 3.8 miles
- Turn right onto WA-9
- Turn left onto E. Highland Dr.
- Turn left onto S. Stillaguamish Ave.
- Hospital will be on the left

FLOOR
1

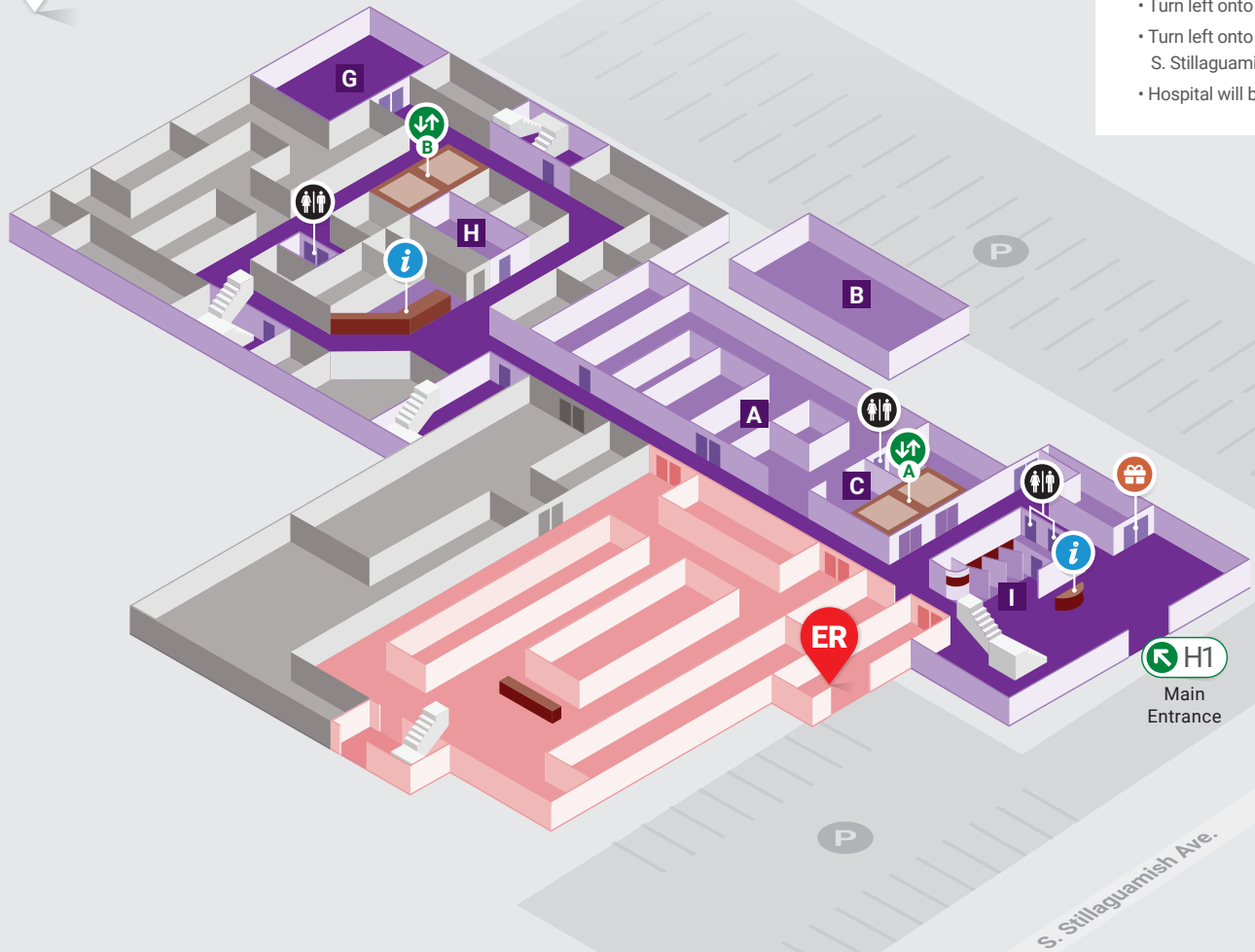

Additional Floors →

1 Cascade Valley Hospital, 1st Floor

- A** Imaging
- B** MRI Building
- C** Laboratory Services
- G** Medical Records
- H** Diabetes Education
- I** Registration
Patient Advocate

ER Emergency Room & After Hours Entrance

- i** Information
- 🎁** Gift Shop
- ♿** Restroom

- ↕ A** Cascade Elevator
- ↕ B** Olympic Elevator

- ➔** Public Entrances
- ER Emergency Room & After Hours Entrance
- H1 Main Entrance

FLOOR
3

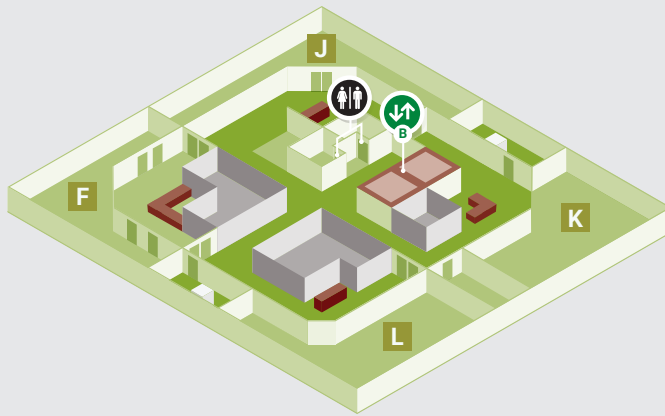

3 Cascade Valley Hospital, 3rd Floor

- F** Family Birthing Center
- J** Surgical Care
- K** Acute Care
- L** Critical Care

FLOOR
2

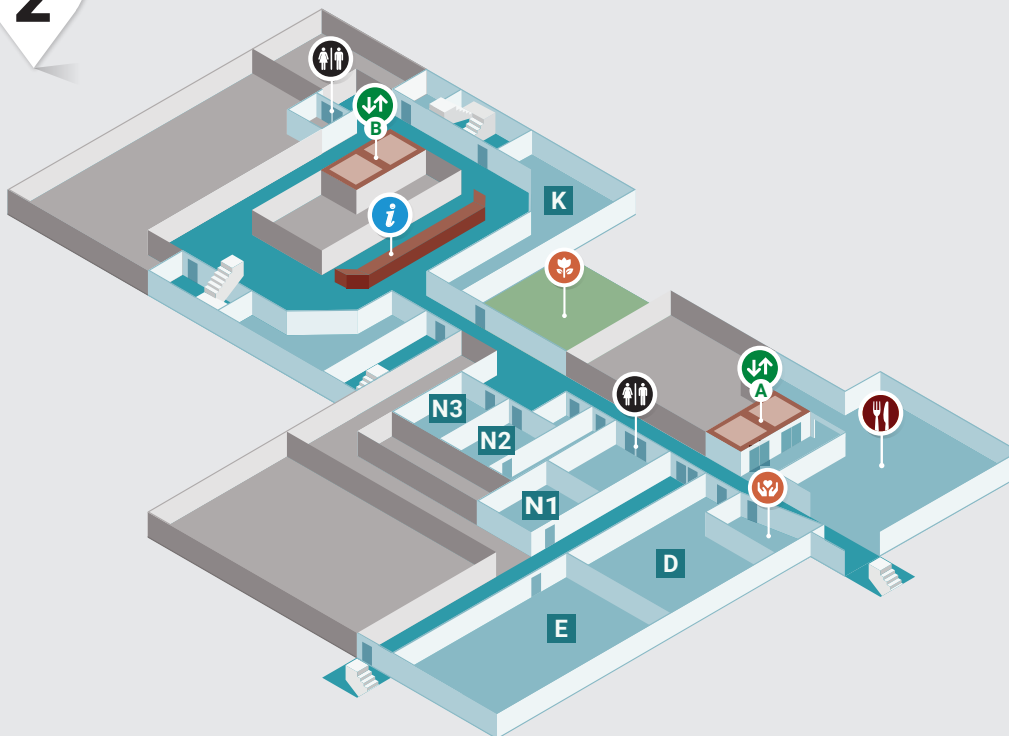

2 Cascade Valley Hospital, 2nd Floor

- D** Cardiopulmonary
- E** Outpatient Physical Therapy
- K** Acute Care
- N1** Pilchuck Conference Room
- N2** Rainier Conference Room A
- N3** Rainier Conference Room B

- Information
- Restroom
- Café
- Reflection Room
- Garden
- Cascade Elevator A
- Olympic Elevator B